

OVERALL DIMENSIONS AND ORDERING CODES

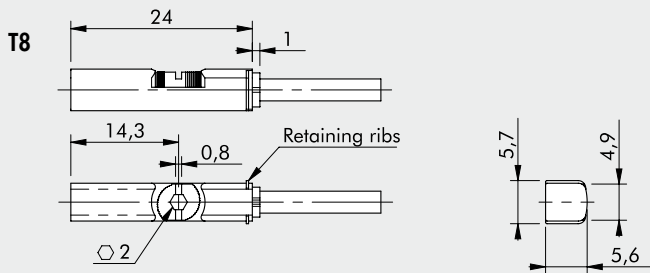
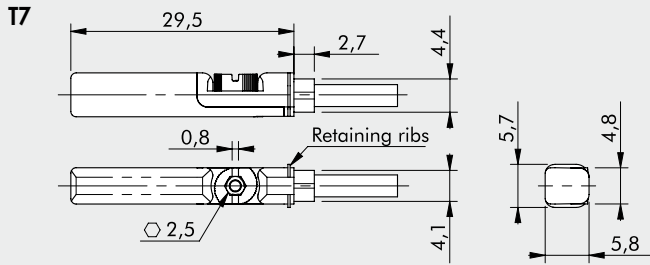

| Code | Description |
|-----------|--|
| T7 | |
| W095414 | REED sensor, T7 SQUARE, 2 wires 2.5 m |
| W095415 | REED sensor, T7 SQUARE, 2 wires 5 m |
| W095416 | REED sensor, T7 SQUARE, 2 wires 10 m |
| W09541C | REED sensor, T7 SQUARE, 2 wires 2.5 m robotics |
| W095411 | REED sensor, T7 SQUARE, 2 wires 300 mm M8 robotics |
| W095434 | HALL sensor, T7 SQUARE, 3 wires 2.5 m |
| W095435 | HALL sensor, T7 SQUARE, 3 wires 5 m |
| W09543C | HALL sensor, T7 SQUARE, 3 wires 2.5 m robotics |
| W095431 | HALL sensor, T7 SQUARE, 3 wires 300 mm M8 robotics |

| | |
|--|--|
| T8 ATEX | |
| W0955A9 | HALL sensor, T8 SQUARE, 3 wires ATEX 2 m SH.OV. robotics |
| T8 (for corrosive environments) | |
| W0952125396 | HALL sensor, T8 SQUARE, 3 wires 2 m HCR |
| W0952129394 | HALL sensor, T8 SQUARE, 3 wires 300 mm M8 HCR |

Note: Not to be used with rodless cylinders Ø 25 having "V" guide.
For this type of cylinder use only the HS version of the oval type.

WIRING DIAGRAM

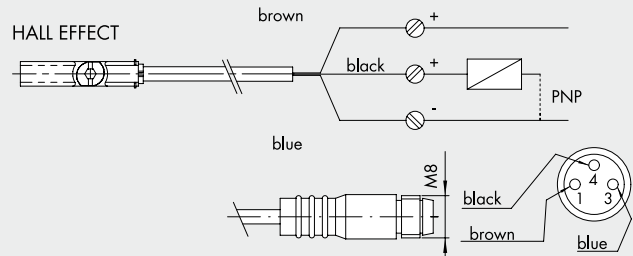
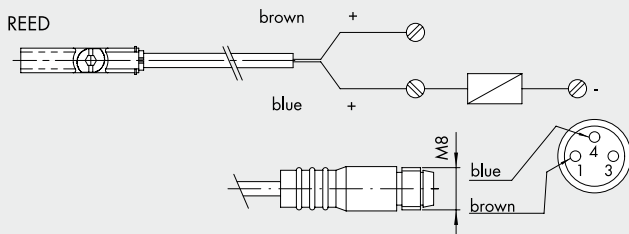

NOTES