



PMAFIX FH-0 - One-piece system supports

The one-piece PMACLIP system support is designed for fixation of PMAFLEX conduits. This product can be used in all machine and installation applications for easy assembly of the PMA system.

Temperature range:

-40°F to +221°F (-40 °C to +105 °C), or a short time up to +320°F (+160°C)

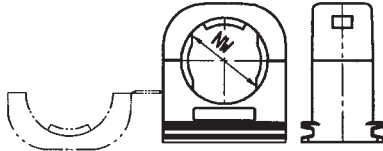

Features:

- high grade formulated polyamide
- excellent impact strength
- self-extinguishing
- free of halogen, phosphor and cadmium

Part No. black	Part No. grey	Fits to conduit size:		Dimensions width x length x depth	Fixing screw
		NW	metric		
I-BFH-07-0	I-SFH-07-0	7	10	17.0 x 21.5 x 20.0	1 x M4
I-BFH-10-0	I-SFH-10-0	10	12	20.5 x 24.5 x 20.0	1 x M5
I-BFH-12-0	I-SFH-12-0	12	16	24.0 x 27.0 x 20.0	1 x M5
I-BFH-17-0	I-SFH-17-0	17	20	30.0 x 34.0 x 20.0	1 x M6
I-BFH-23-0	I-SFH-23-0	23	25	38.5 x 42.0 x 20.0	1 x M6
I-BFH-29-0	I-SFH-29-0	29	32	45.5 x 48.0 x 20.0	1 x M6
I-BFH-36-0	I-SFH-36-0	36	40	55.5 x 56.0 x 20.0	1 x M6
I-BFH-48-0	I-SFH-48-0	48	50	67.5 x 68.0 x 20.0	1 x M6



PMAFIX VH - System supports

These PMACLIP system supports are designed for support and guidance of PMA conduits with fine or coarse profile and can be used in all machine building and installation applications. The system is safe against turning/movement and offers maximum security with the additional safety clip, variable assembly due to six hole fastening and optimal strain relief due to integrated rib.

Temperature range:

-40°F to +221°F (-40 °C to +105 °C), or a short time up to +320°F (+160°C)

Features:

- high grade formulated polyamide
- excellent impact strength
- self-extinguishing
- free of halogen, phosphor and cadmium

Part No. Support only	Part No. Locking clip	Part No. Complete	Fits to conduit size:		Dimensions width x length x depth	Fixing screw
			NW	metric		
I-BVH-07	BVH-07-020	BVH-07-000	7	10	17.0 x 21.5 x 20.0	1 x M4
I-BVH-10	BVH-10-020	BVH-10-000	10	12	20.5 x 24.5 x 20.0	1 x M5
I-BVH-12	BVH-12-020	BVH-12-000	12	16	24.0 x 27.0 x 20.0	1 x M5
I-BVH-17	BVH-17-020	BVH-17-000	17	20	35.0 x 36.0 x 36.0	6 x M5
I-BVH-23	BVH-23-020	BVH-23-000	23	25	35.0 x 44.0 x 36.0	6 x M5
I-BVH-29	BVH-29-020	BVH-29-000	29	32	46.0 x 52.0 x 40.0	6 x M5
I-BVH-36	BVH-36-020	BVH-36-000	36	40	53.0 x 58.0 x 60.0	6 x M5
I-BVH-48	BVH-48-020	BVH-48-000	48	50	66.0 x 72.0 x 60.0	6 x M5



PMAFIX GPS - One-piece System supports for stacking

The PMAFIX system supports for stacking are specially designed for increased mechanical requirements in the traction and heavy machine building industries. The one-piece systems supports offer a clasp for easy pre-mounting and final assembly. Fixation in standard rails type C and strain relief due to gripping around the conduit. In addition these products are partially stackable.

Temperature range:

-40°F to +221°F (-40 °C to +105 °C), or a short time up to +320°F (+160°C)

Features:

- high grade formulated polyamide
- excellent impact strength
- self-extinguishing
- free of halogen, phosphor and cadmium

Stacking options

The following nominal widths can be combined for stacking:

- NW 17 with NW23
- NW 29 with NW 36
- NW 48 with NW 56

Part No. fine profile	Fits to conduit size			Dimensions		
	NW	metric	DIN-NW	width	height	depth
BGPS-17	17	20	2	70.0	45.0	30.0
BGPS-23	23	25	2	70.0	45.0	30.0
BGPS-29	29	32	3	85.0	60.0	30.0
BGPS-36	36	40	3	85.0	60.0	30.0
BGPS-48	48	50	4	115.0	90.0	30.0
BGPS-56	56	-	4	115.0	90.0	30.0



PMA MN - Hexagonal Lock Nuts, metric & PG

These hexagonal lock nuts are suitable for a wide range of applications. High torque guarantees a safe connection of the system. Made of reinforced polyamide glass fiber

Temperature range:

-40°F to +221°F (-40 °C to +105 °C), or a short time up to +302°F (+150°C)

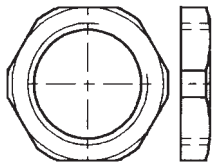

Part No. black	Part No. grey	Fits to thread: metric	Wrench size	Dimensions height
I-BMN-M12	I-GMN-M12	M12 x 1.5	17.0	5.0
I-BMN-M16	I-GMN-M16	M16 x 1.5	22.0	5.0
I-BMN-M20	I-GMN-M20	M20 x 1.5	27.0	6.0
I-BMN-M25	I-GMN-M25	M25 x 1.5	32.0	6.0
I-BMN-M32	I-GMN-M32	M32 x 1.5	41.0	7.0
I-BMN-M40	I-GMN-M40	M40 x 1.5	50.0	7.0
I-BMN-M50	I-GMN-M50	M50 x 1.5	60.0	8.0
I-BMN-M63	I-GMN-M63	M63 x 1.5	75.0	8.0

Part No. black	Part No. grey	Fits to thread: PG	Wrench size	Dimensions height
I-BMN-07	I-GMN-07	7	19.0	5.0
I-BMN-09	I-GMN-09	9	22.0	5.0
I-BMN-11	I-GMN-11	11	24.0	5.3
I-BMN-13	I-GMN-13	13.5	27.0	6.3
I-BMN-16	I-GMN-16	16	30.0	6.3
I-BMN-21	I-GMN-21	21	36.0	7.0
I-BMN-29	I-GMN-29	29	46.0	7.0
I-BMN-36	I-GMN-36	36	60.0	8.0
I-BMN-48	I-GMN-48	48	70.0	8.0

igus® Energy Chain System®

Telephone 1-800-521-2747
Fax 1-401-438-7270

Internet: <http://www.igus.com>
email: sales@igus.com
QuickSpec: <http://www.igus.com/quickspec>

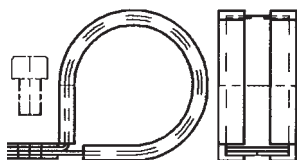

PMA SGB - Tube clamps

These tube clamps are used for the mounting and smooth connection to the PMA conduits in the general machine and installation applications. They are especially suitable for the mounting of static conduits.

Temperature range: -58°F to +221°F (-50 °C to +105 °C)

Features:

- galvanized steel according to DIN 3016
- Elastomer free of halogen

Part No.	Fits to conduit size		Dimensions width [mm]	Fixing screw
	NW	metric		
I-SGB-07	7	10	13.0	1 x M4
I-SGB-09	10	12	13.0	1 x M4
I-SGB-11	12	16	13.0	1 x M4
I-SGB-16	17	20	16.0	1 x M5
I-SGB-21	23	25	16.0	1 x M5
I-SGB-29	29	32	19.0	1 x M6
I-SGB-36	36	40	19.0	1 x M6
I-SGB-48	48	50	19.0	1 x M6

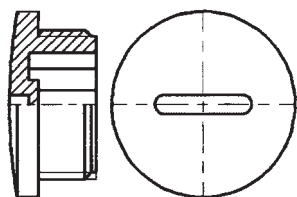

PMA 514 - Plug Screws, metric & PG

These plug screws are suitable for an accurate termination where no thread holes in casing and distribution boxes are needed.

Temperature range: -4°F to +212°F (-20 °C to +100 °C), or a short time up to +302°F (+150°C)

Features:

- product with metric thread: PA-GF
- product with PG thread: PS
- free of halogen, phosphor and cadmium
- IP54

Part No.	Fits to thread		Outside Ø [mm]	Total length [mm]	Thread length [mm]
	metric				
I-514-M12	M12 x 1.5		15.0	8.0	6.0
I-514-M16	M16 x 1.5		20.0	9.0	6.0
I-514-M20	M20 x 1.5		24.0	9.5	6.0
I-514-M25	M25 x 1.5		30.0	11.5	8.0
I-514-M32	M32 x 1.5		37.0	12.0	8.0
I-514-M40	M40 x 1.5		46.0	13.0	8.0
I-514-M50	M50 x 1.5		56.0	15.0	10.0
I-514-M63	M63 x 1.5		70.0	17.0	12.0

Part No.	Fits to thread		Outside Ø [mm]	Total length [mm]	Thread length [mm]
	PG				
I-514-07	7		15.0	8.0	6.0
I-514-09	9		19.0	9.5	6.5
I-514-11	11		22.0	10.0	6.5
I-514-13	13.5		25.0	10.0	6.5
I-514-16	16		27.0	10.0	6.5
I-514-21	21		33.0	12.0	8.0
I-514-29	29		44.0	11.5	8.0
I-514-36	36		55.0	14.0	10.0
I-514-48	48		68.0	16.0	12.0