

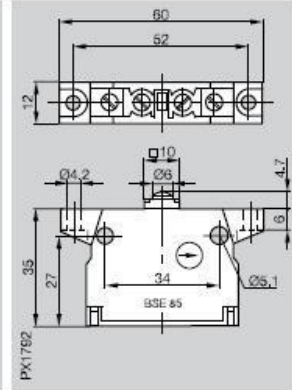

Mechanical Switches

Replacement Switch Elements

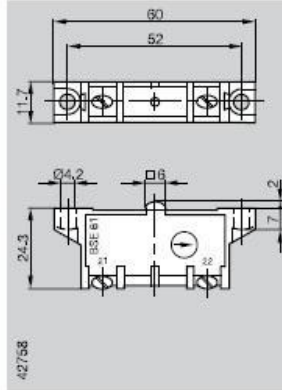
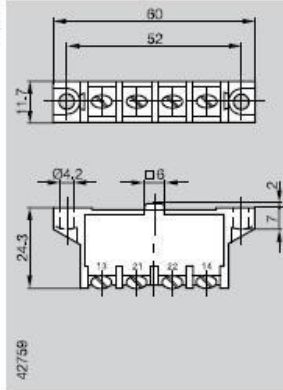

Type	Snap switch element BSE 30.0	Creep switch element BSE 61 to DIN EN 60204-1	Snap switch element BSE 85 to DIN EN 60204-1
for multiple position switches series	100, 62, 61, 72	100, 62, 61, 72	100, 62, 61, 72
for single position switches series	F 60	F 60	F 60

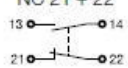

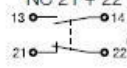
Part number	BSE 30.0-RK	BSE 61-RK	BSE 85-RK
Construction			
Contact material	Silver, gold plated	Silver	Silver
Switching principle	Snap switch	Creep switch, positive-opening	Snap switch, positive opening (normally-closed)
Contact system	Dual changeover, one normally open and one normally closed, galvanically isolated	Normally-closed, double interruption	Dual-changeover: 1. NO (snap function), 2. Positive-opening (double-interruption), all galvanically isolated
Contact arrangement	NO 13 + 14 NC 21 + 22 	NC 21 + 22 	NO 13 + 14 NC 21 + 22 
Wire AWG	2 x 16 AWG	2 x 16 AWG	2 x 16 AWG
Connection type	Screw connection M3	Screw connection M3	Screw terminal M3.5
Mechanical data			
Switching actuation force on telescoping plunger	min. 20 N		
Switching actuation force on rigid plunger		min. 15 N	min. 30 N
Bounce time	≤ 1.5 ms		≤ 3 ms
Switchover time	≤ 10 ms		≤ 5 ms
Switching frequency	300 operations/min	300 operations/min	160 operations/min
Housing material	Duro- and Thermoplast	Duro- and Thermoplast	Thermoplast
Tightening torque max.	0.5 Nm	0.5 Nm	0.9 Nm
Ambient temperature range T _a	-5...+85 °C	-5...+85 °C	-5...+85 °C
Electrical data			
Isolation	Group C (VDE 0110)	Group C (VDE 0110)	Group C (VDE 0110)
Nominal voltage	240 V AC	250 V AC	250 V AC
Nominal current	6 A	6 A	6 A
Constant current	≥ 20 mA	≥ 20 mA	≥ 20 mA
Minimum load at 24 V DC	< 40 mΩ	< 40 mΩ	< 40 mΩ
Contact resistance	6 A, cos φ = 1		
Switching capacity	AC 250 V 40...60 Hz 220 V	Depends on traverse speed and switching frequency	2 A, cos φ = 0.8