

• Passe-fils série DC à épaulements égaux

| type | code article | dimensions (mm) | | | | | | pces |
|----------------|---------------|-----------------|-------|-------|------|------|------|------|
| | | A | B | C | D | F1 | F2 | |
| DC 50/70/10 | 0252 0214 010 | 5,0 | 7,0 | 11,0 | 1,0 | 2,0 | 3,5 | 100 |
| DC 51/70/15 | 0252 0213 010 | 5,1 | 7,0 | 11,0 | 1,5 | 3,0 | 3,0 | 100 |
| DC 70/250/60 | 0252 0220 010 | 7,0 | 25,0 | 29,0 | 6,0 | 2,0 | 2,0 | 100 |
| DC 90/110/10 | 0252 0201 010 | 9,0 | 11,0 | 16,0 | 1,0 | 3,25 | 3,25 | 100 |
| DC 90/110/15 | 0252 0202 010 | 9,0 | 11,0 | 16,0 | 1,5 | 3,25 | 3,25 | 100 |
| DC 90/110/20 | 0252 0203 010 | 9,0 | 11,0 | 16,0 | 2,0 | 3,25 | 3,25 | 100 |
| DC 90/110/30 | 0252 0204 010 | 9,0 | 11,0 | 16,0 | 3,0 | 3,25 | 3,25 | 100 |
| DC 90/110/40 | 0252 0212 010 | 9,0 | 11,0 | 16,0 | 4,0 | 3,25 | 3,25 | 100 |
| DC 190/250/65 | 0252 0206 010 | 19,0 | 25,0 | 32,0 | 6,5 | 3,0 | 3,0 | 50 |
| DC 190/250/135 | 0252 0207 010 | 19,0 | 25,0 | 32,0 | 13,5 | 3,0 | 3,0 | 50 |
| DC 940/1010/30 | 0252 0211 010 | 94,0 | 101,0 | 109,0 | 3,0 | 5,5 | 5,5 | 25 |

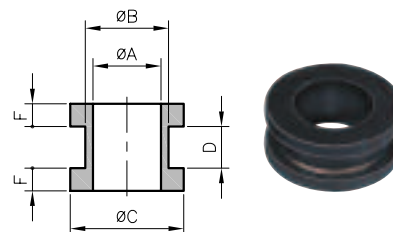

• Passe-fils série DC à épaulements inégaux

| type | code article | dimensions (mm) | | | | | | pces |
|-------------|---------------|-----------------|-----|------|-----|-----|-----|------|
| | | A | B | C | D | F1 | F2 | |
| DC 50/70/10 | 0252 0214 010 | 5,0 | 7,0 | 11,0 | 1,0 | 2,0 | 3,5 | 100 |

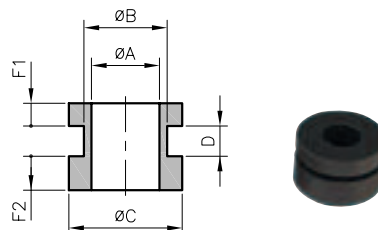

• Passe-fils série DE à épaulements inégaux

| type | code article | dimensions (mm) | | | | | | pces |
|--------------|---------------|-----------------|------|-------|-----|-----|-----|------|
| | | A | B | C | D | F1 | F2 | |
| DE 65/100/10 | 0252 0299 010 | 6,5 | 10,0 | 16/14 | 1,0 | 3,0 | 5,0 | 100 |
| DE 65/100/15 | 0252 0308 010 | 6,5 | 10,0 | 16/14 | 1,5 | 3,0 | 5,0 | 100 |
| DE 65/100/20 | 0252 0304 010 | 6,5 | 10,0 | 16/14 | 2,0 | 3,0 | 5,0 | 100 |
| DE 65/100/30 | 0252 0300 010 | 6,5 | 10,0 | 16/14 | 3,0 | 3,0 | 5,0 | 100 |

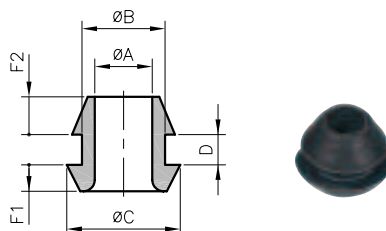

• Passe-fils série DH à un seul épaulement

| type | code article | dimensions (mm) | | | | | pces |
|----------------|---------------|-----------------|------|------|------|------|------|
| | | A | B | C | D | F1 | |
| DH 60/90/80 | 0252 0340 010 | 6,0 | 9,0 | 14,0 | 8,0 | 3,0 | 100 |
| DH 80/115/50 | 0252 0321 010 | 8,0 | 11,5 | 16,0 | 5,0 | 4,0 | 100 |
| DH 80/115/80 | 0252 0322 010 | 8,0 | 11,5 | 16,0 | 8,0 | 4,0 | 100 |
| DH 80/115/160 | 0252 0323 010 | 8,0 | 11,5 | 16,0 | 16,0 | 4,0 | 100 |
| DH 120/200/200 | 0252 0326 010 | 12,0 | 20,0 | 27,5 | 20,0 | 5,0 | 50 |
| DH 130/200/150 | 0252 0328 010 | 13,0 | 20,0 | 28,0 | 15,0 | 5,0 | 100 |
| DH 140/200/200 | 0252 0327 010 | 14,0 | 20,0 | 28,0 | 20,0 | 5,0 | 50 |
| DH 240/300/350 | 0252 0324 010 | 24,0 | 30,0 | 38,0 | 35,0 | 5,0 | 25 |
| DH 250/310/330 | 0252 0320 010 | 25,0 | 31,0 | 37,0 | 33,0 | 5,0 | 25 |
| DH 300/390/400 | 0252 0329 010 | 30,0 | 39,0 | 55,0 | 40,0 | 10,0 | 25 |
| DH 350/450/500 | 0252 0341 010 | 35,0 | 45,0 | 57,0 | 50,0 | 10,0 | 25 |

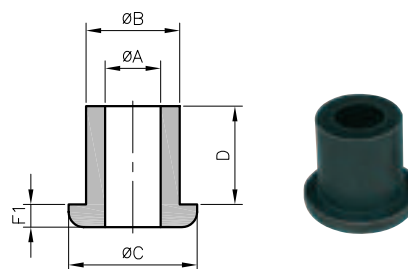

Nouveau