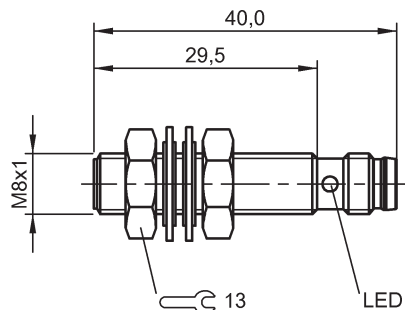

not available

Please note: This particular product is scheduled to be phased out. Only remaining stock is sold. More information can be found on www.balluff.com. You may also get in touch with your local Balluff representative if you need additional assistance.

- PNP
- Normally open (NO)
- 2.00 mm
- Flush (shielded)
- Connector, M08x1-S49

**General attributes**

Approvals / Conformity	CE
Basic standard	cULus
Enclosure Type per IEC 60529	IEC 60947-5-2
Function indicator	IP67
Operating distance marking	Yes
Polarity reversal protected	■ ■
Power indicator	Yes
Short circuit protected	No
Trademark	Yes
	GLOBALPROX

Electrical attributes

Connection type	Connector
Eff. operating current Ie	200 mA
Eff. operating voltage Ue DC	24.0 V
Electrical version	DC, direct current
Load capacitance max. (at Ue)	0.500 µF
Max. no-load cur. I _o undamped	3.0 mA
Minimum operating current I _m	0 mA
No-load current I _o damped max.	9.0 mA
Operating voltage UB max. DC	30.0 V
Operating voltage UB min. DC	10.0 V
Rated insulation voltage Ui	250 VAC

Rated short circuit current	100 A
Ripple max. (% of Ue)	15 %
Switching function	Normally open (NO)
Switching output	PNP
Voltage drop static max.	2.5 V

Mechanical attributes

Ambient temperature Ta max.	70 °C
Ambient temperature Ta min.	-25 °C
Assured operating distance Sa	1.60 mm
Connector type	M08x1-S49
Depth	M08x1
Diameter d1	40.0 mm
Eff. operating distance Sr	2.00 mm
Housing material	Stainless steel
Mech. installation condition	Flush (shielded)
Mounting length	29.1 mm
Rated operating distance Sn	2.00 mm
Sensing face material	PBT
Tightening torque	8 Nm

Additional text

With connector, e.g. BKS-S 49-... total length = switch length +12 mm.
The sensor is functional again after the overload has been eliminated.

